



**BRAKE PUMP
PROTECTION DTC**
Ref.: 2AD2500128



Assembly Booklet / Paper collection
Livret de montage / Collecte de papier



Mini Zip Bag / Plastic collection
Mini sac zip / Collecte de plastique



Box / Paper collection
Boîte / Collecte de papier



Carton Separator / Paper collection
Séparateur de cartons / Collecte de papier



Card Header / Paper collection
Carte d'en-tête / Collecte de papier



Plastic Bag Cover / Plastic collection
Couverte de sac en plastique / Collecte de plastique



ASSEMBLY INSTRUCTION / INSTRUÇÃO DE MONTAGEM

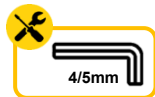
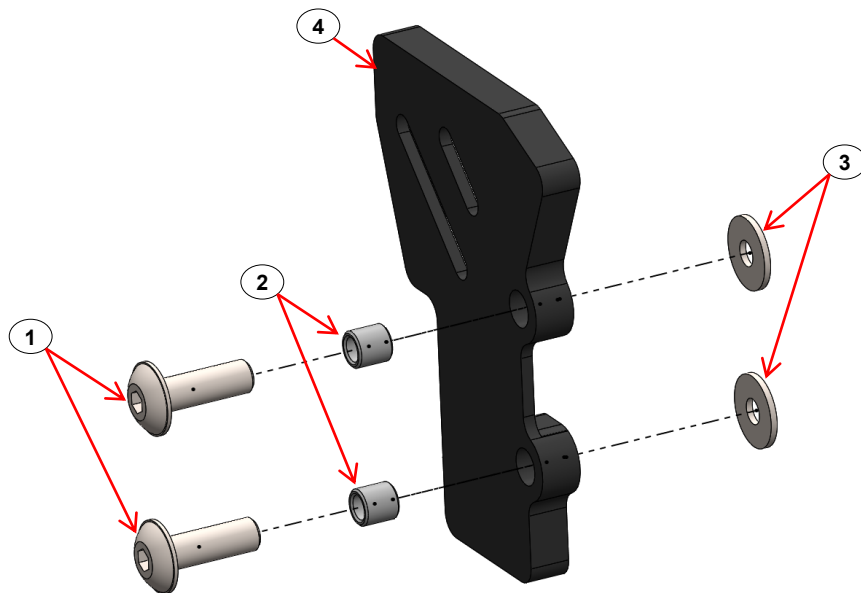

Nm	STAINLESS	
	STEEL	STEEL
	8.8	A2
M4	2.7	2.6
M5	5.5	5.1
M6	9.7	8.7
M8	23.0	21.2
M10	47.0	42.0
M12	80.0	73.0

ITEM Nº:	COMPONENTE (COMPONENT):	DESCRIÇÃO (DESCRIPTION):	QUANT.:
4	Prot. Bomba Travão DTC / Brake Pump Protection DTC	128	1
3	Anilha Aba Larga / Large Washer	M6 DIN9021 8.8	2
2	Casquilho AL / Aluminum Bushing	Ø9xØ6x9mm - HCQ01A0001	2
1	Parafuso com FA / Screw with Washer False	M6x25 FA ISO7380 8.8	2
ACESSÓRIOS (ACCESSORIES)			

BRAKE PUMP PROTECTION DTC

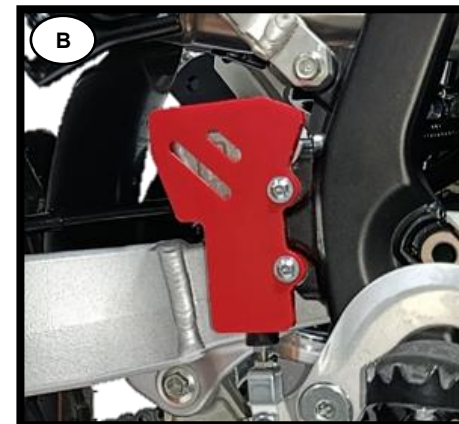
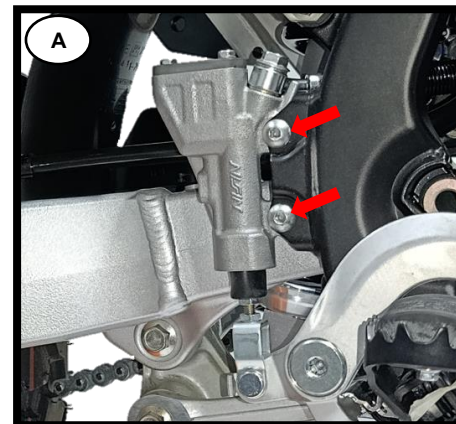

English:

Attention: Follow the installation sequence as you can see in the photos.

• **Photo A:** Remove OEM screws (x2) marked in the photo.

• **Photo B:** Assemble protection according assembly instruction.

► **ATTENTION:** add a little medium strength loctite and torque the screw to the correct value.

Português:

Atenção – Seguir a sequência de montagem que pode ver nas fotos.

• **Foto A:** Remover parafusos OEM (x2) marcados na foto.

• **Foto B:** Montar proteção de acordo com a instrução de montagem.

► **ATENÇÃO:** adicionar um pouco de loctite no parafuso e apertar o parafuso com o valor correto de torque.

Français:

Attention: Suivre le séquence de photos d'assemblage.

• **Photo A:** Enlever les vis OEM (x2) marqués sur la photo.

• **Photo B:** Assembler la protection conformément aux instructions de montage.

► **ATTENTION:** ajouter un peu de loctite sur le vis et torque le vis avec le bonne valeur.